

PRODEMAND

Service Manual: CONVENTIONAL BRAKE SYSTEM

2014 Honda Pilot 3.5L Eng Touring

Print Date: 11/7/2017

FRONT BRAKE PAD INSPECTION AND REPLACEMENT

Special Tools Required

Brake Caliper Piston Compressor 07AAE-SEPA101

CAUTION: *Frequent inhalation of brake pad dust, regardless of material composition, could be hazardous to your health.*

- *Avoid breathing dust particles.*
- *Never use an air hose or brush to clean brake assemblies. Use an OSHA-approved vacuum cleaner.*

for specific model

FRONT BRAKE PAD INSPECTION AND REPLACEMENT > INSPECTION

1. Raise and support the vehicle (see LIFT AND SUPPORT POINTS).
2. Remove the front wheels.
3. Check the thickness (A) of the inner pad (B) and the outer pad (C). Do not include the thickness of the backing plate.

Brake pad thickness:

Standard: 11.0 mm (0.433 in)

Service limit: 1.6 mm (0.063 in)

Inner pad

Fig 1: Identifying Brake Pad Thickness (Inner Pad)

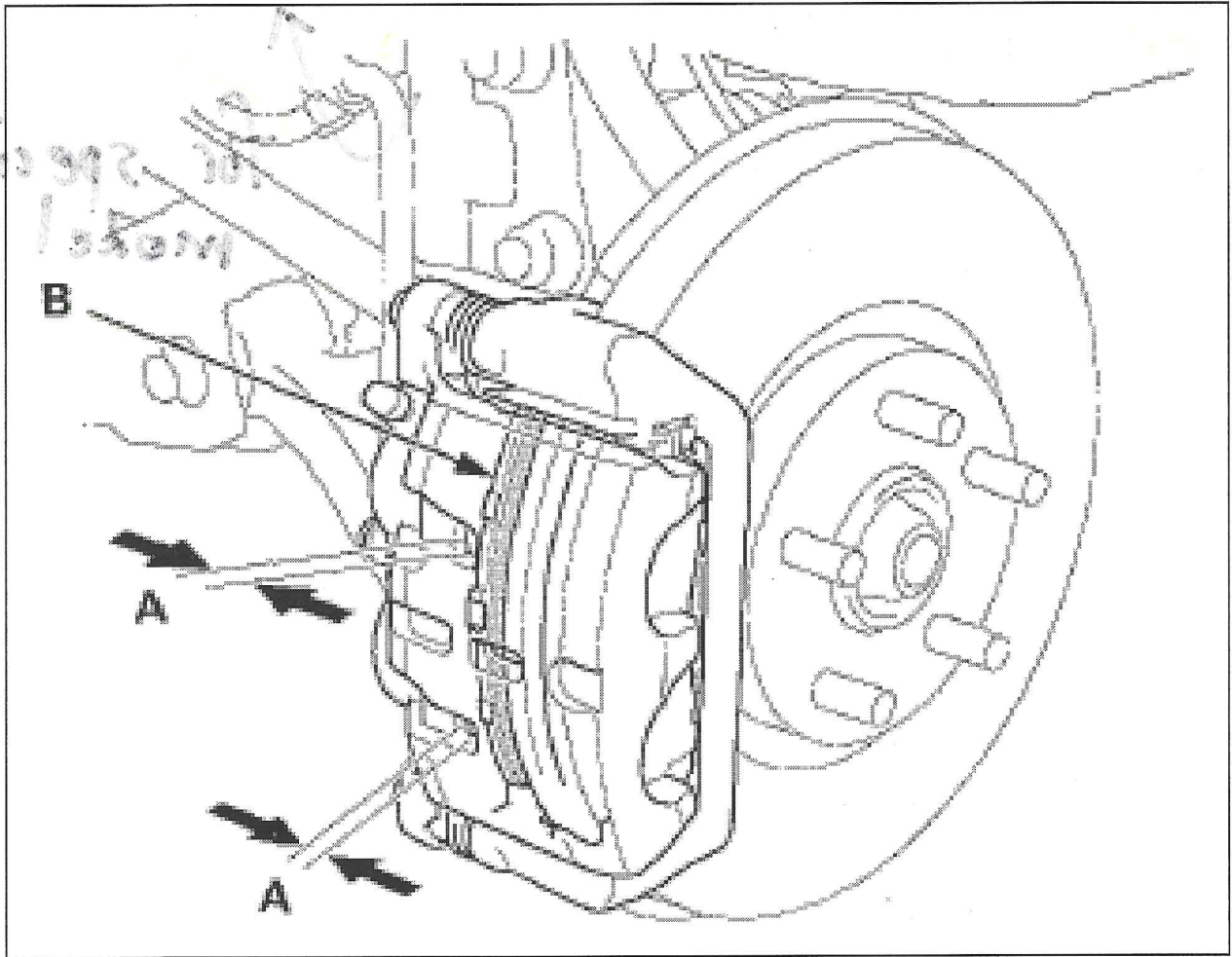

Courtesy of AMERICAN HONDA MOTOR CO., INC.

Outer pad

Fig 2: Identifying Brake Pad Thickness (Outer Pad)

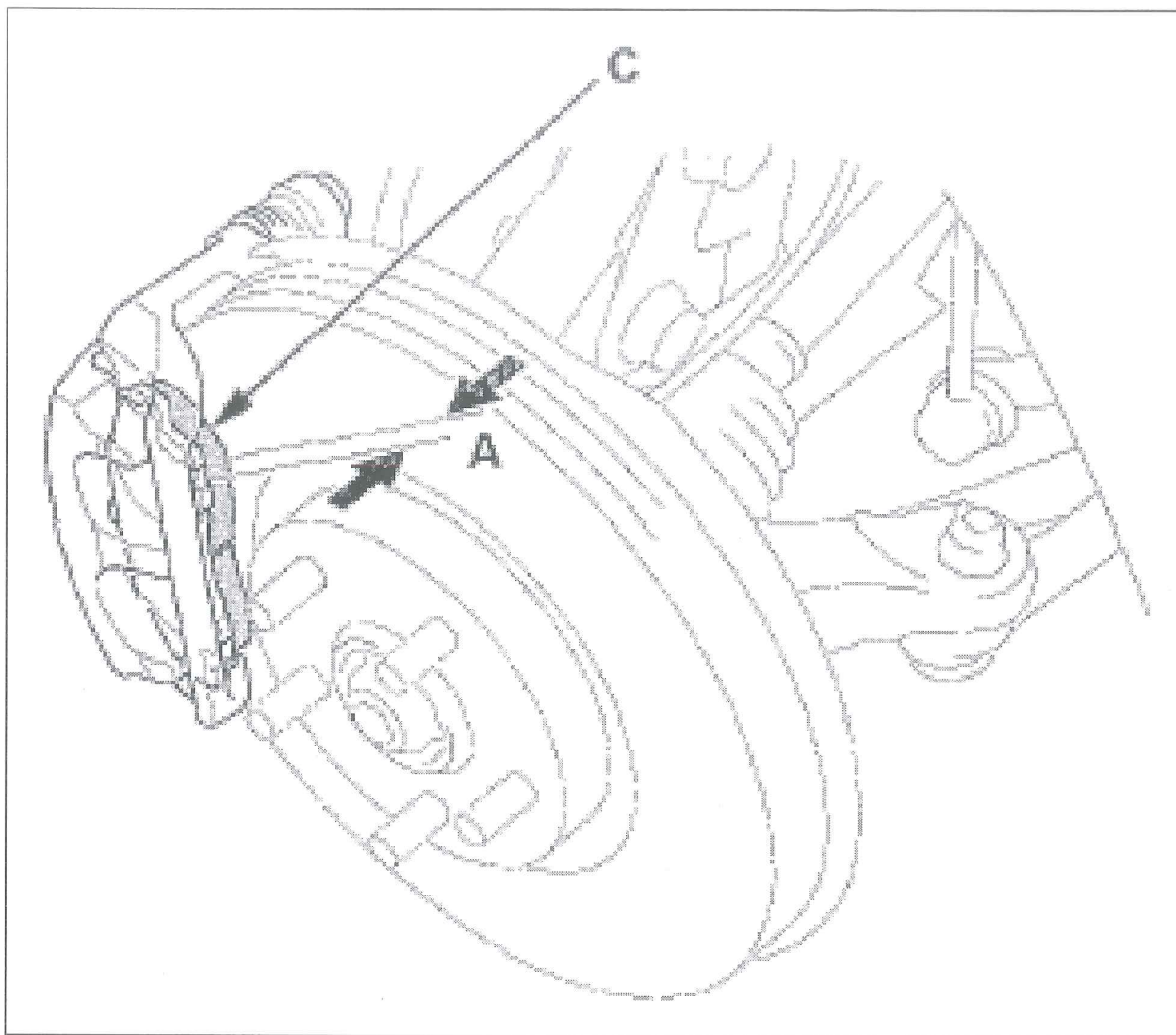

Courtesy of AMERICAN HONDA MOTOR CO., INC.

4. If any part of the brake pad thickness is less than the service limit, replace the front brake pads as a set.
5. Clean the mating surfaces between the brake disc and the inside of the wheel, then install the front wheels.

FRONT BRAKE PAD INSPECTION AND REPLACEMENT > REPLACEMENT

1. Remove some brake fluid from the master cylinder.
2. Raise and support the vehicle (see LIFT AND SUPPORT POINTS).
3. Remove the front wheels.
4. Remove the flange bolt (A), and pivot the caliper (B) up out of the way. Check the hose and the pin boots for damage and deterioration.

Fig 1: Pivoting Caliper To Up Position

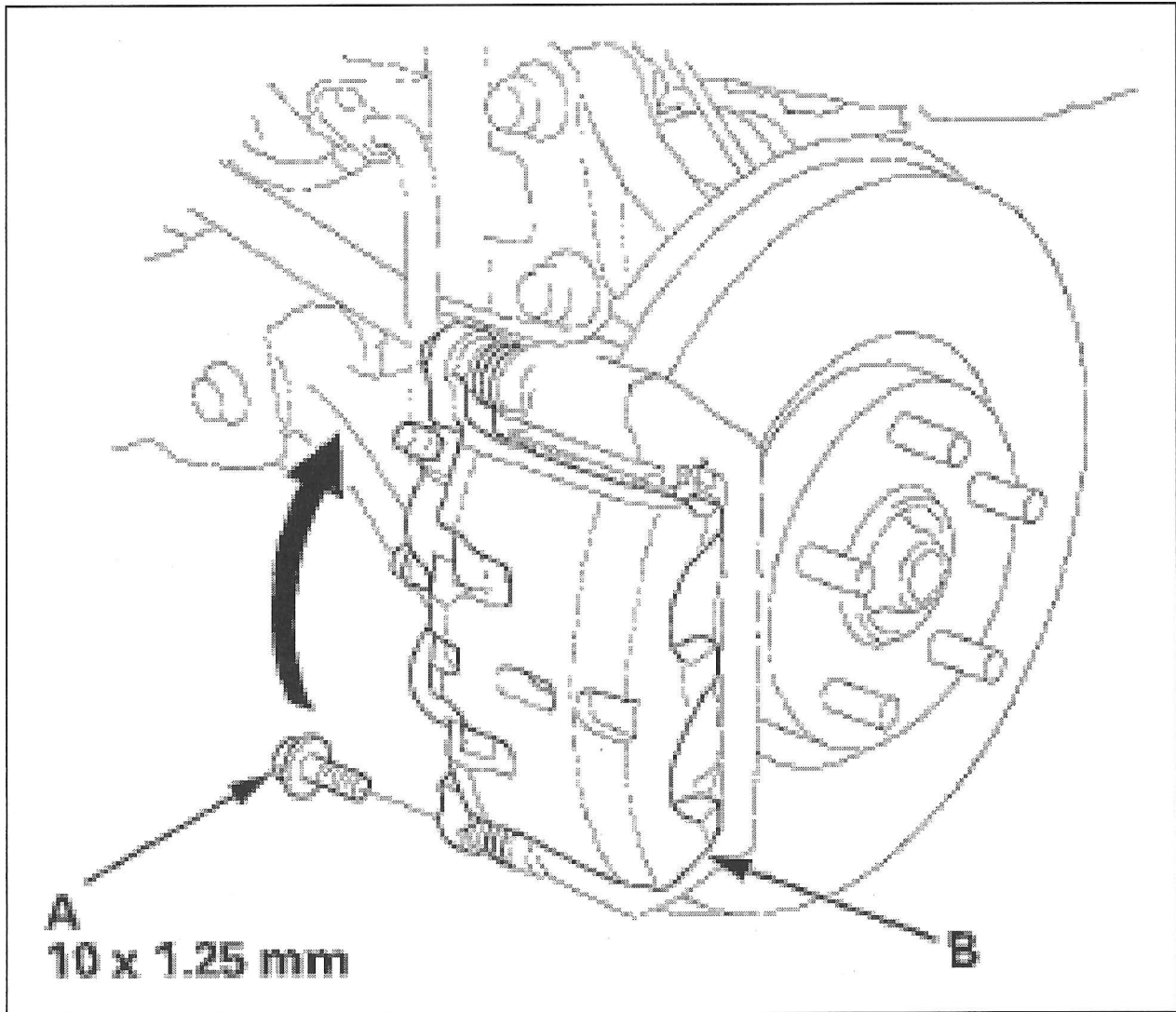

Courtesy of AMERICAN HONDA MOTOR CO., INC.

5. Remove the pad springs (A) while holding the brake pads.

NOTE: The pad return springs are installed on the pads to prevent brake drag. Be careful when pivoting the caliper body up or the spring could pop out of position.

Fig 2: Identifying Pad Springs

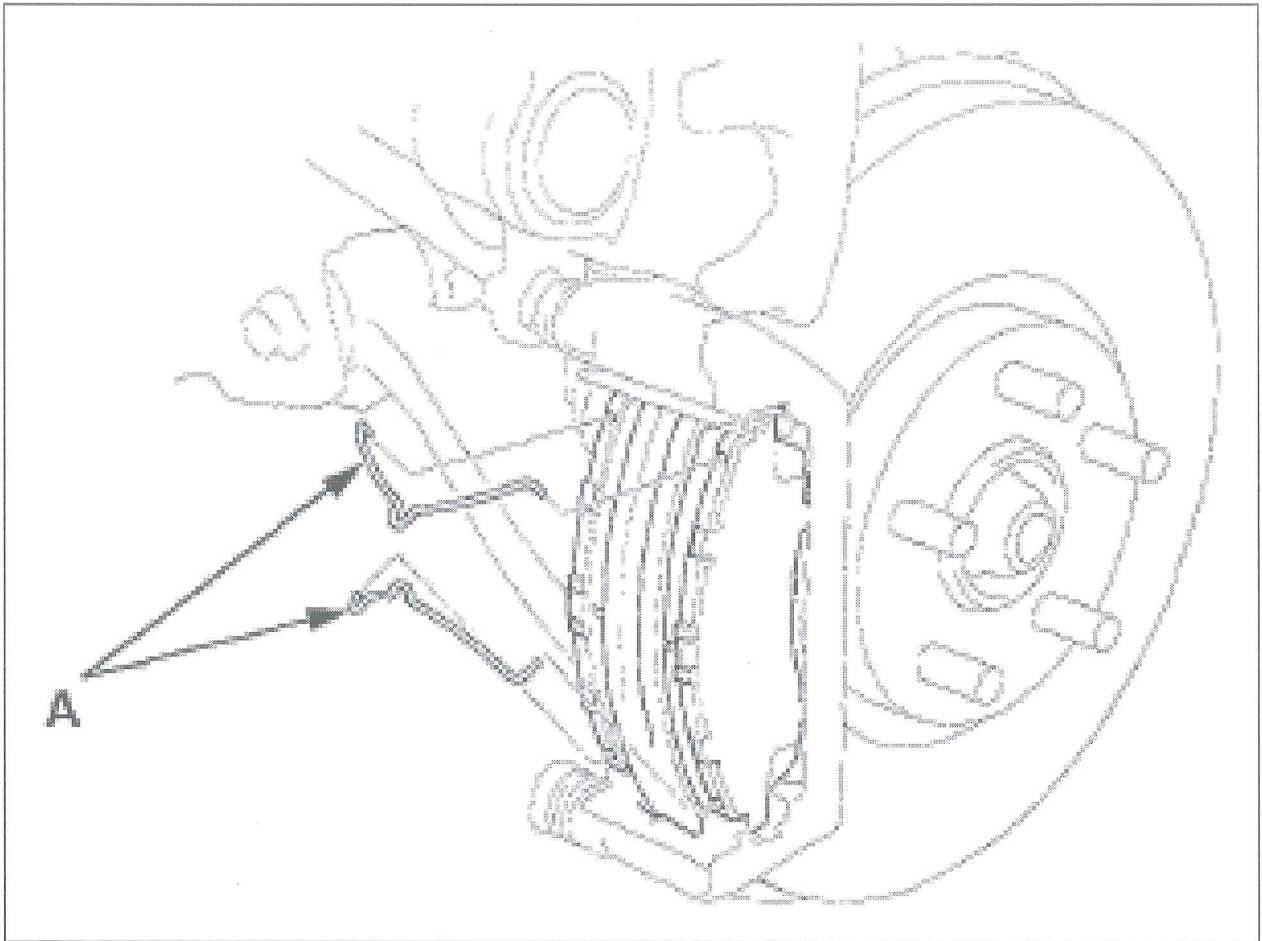

Courtesy of AMERICAN HONDA MOTOR CO., INC.

6. Remove the pad shims (A) and the brake pads (B).

Fig 3: Identifying Pad Shims And Brake Pads

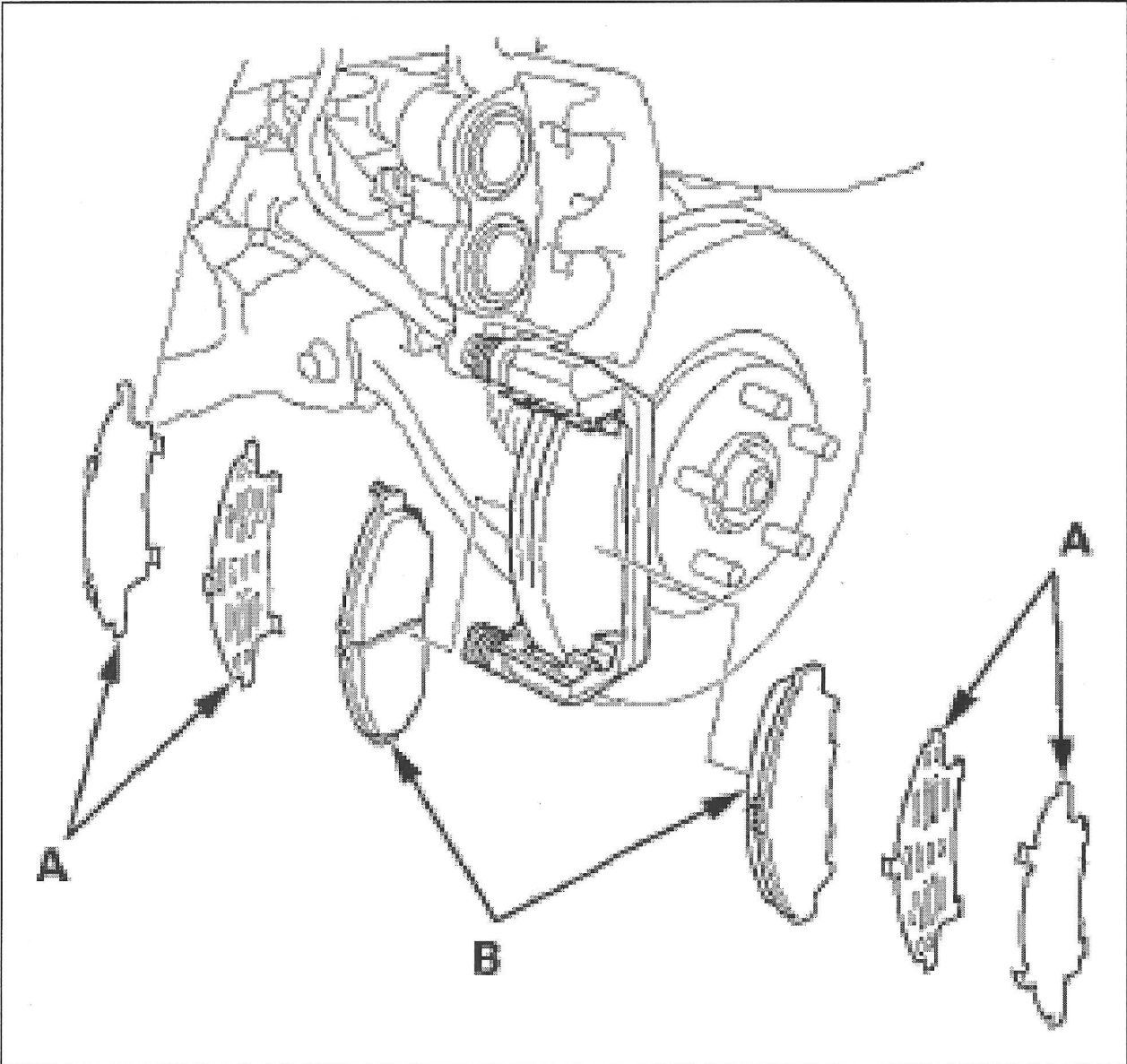

Courtesy of AMERICAN HONDA MOTOR CO., INC.

7. Remove the pad retainers (A).

NOTE: *The upper and lower pad retainers are different. During installation, make sure the pad retainers are in proper positions.*

Fig 4: Identifying Pad Retainers, Caliper Bracket And Pins

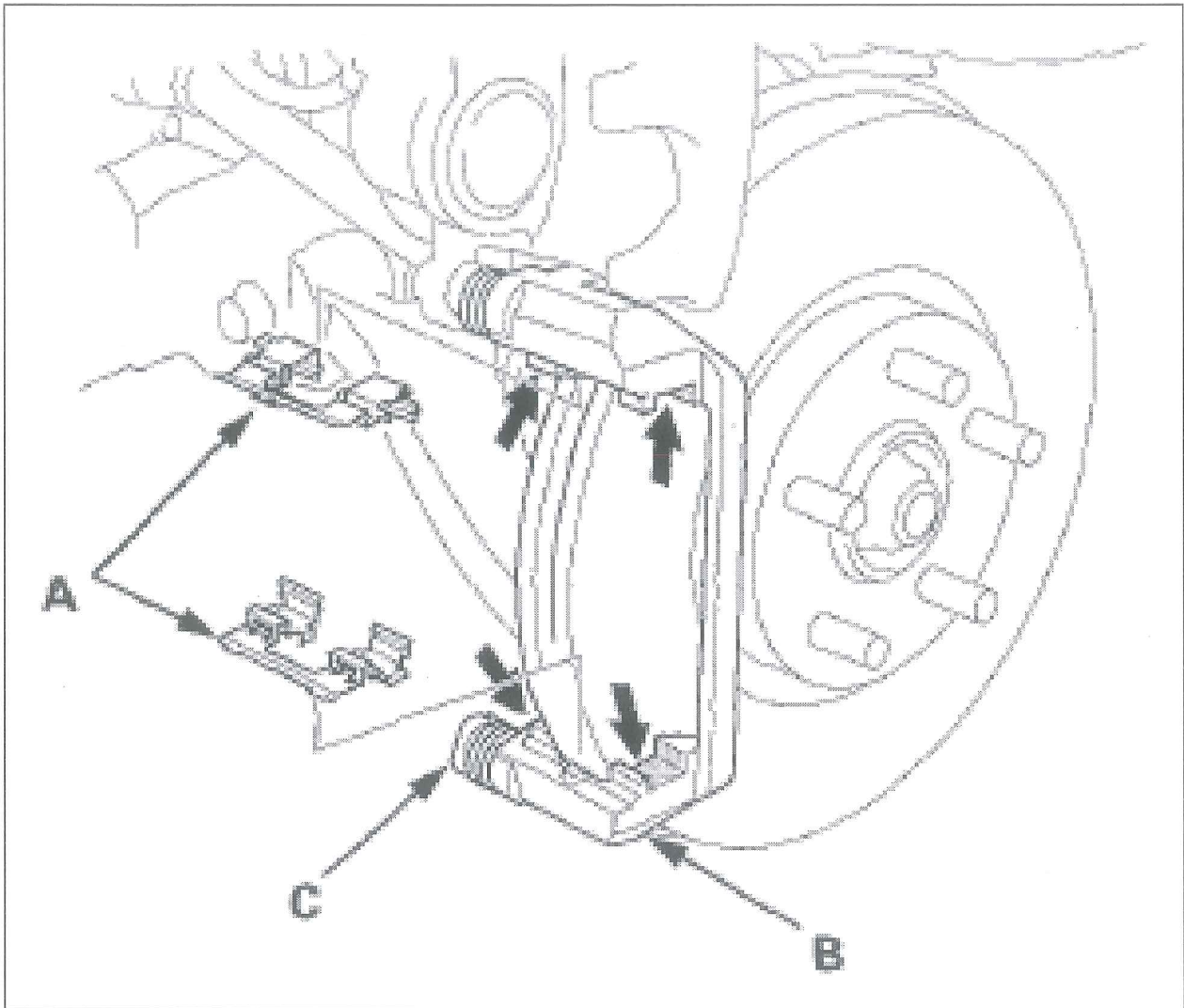

Courtesy of AMERICAN HONDA MOTOR CO., INC.

8. Clean the caliper bracket (B) thoroughly; remove any rust, and check for grooves and cracks. Verify that the caliper pins (C) move in and out smoothly. Clean and lube if needed.
9. Inspect the brake disc, for runout, thickness, parallelism (see THICKNESS AND PARALLELISM) and check for damage and cracks.
10. Apply a thin coat of M-77 assembly paste (P/N 08798-9010) to the retainer mating surface of the caliper bracket (indicated by the arrows).
11. Install the pad retainers. Wipe off excess assembly paste from the retainers. Keep the assembly paste away from the brake disc and the brake pads.
12. Install the brake caliper piston compressor tool (A) on the caliper body (B).

Fig 5: Installing Brake Caliper Piston Compressor Tool On Caliper Body

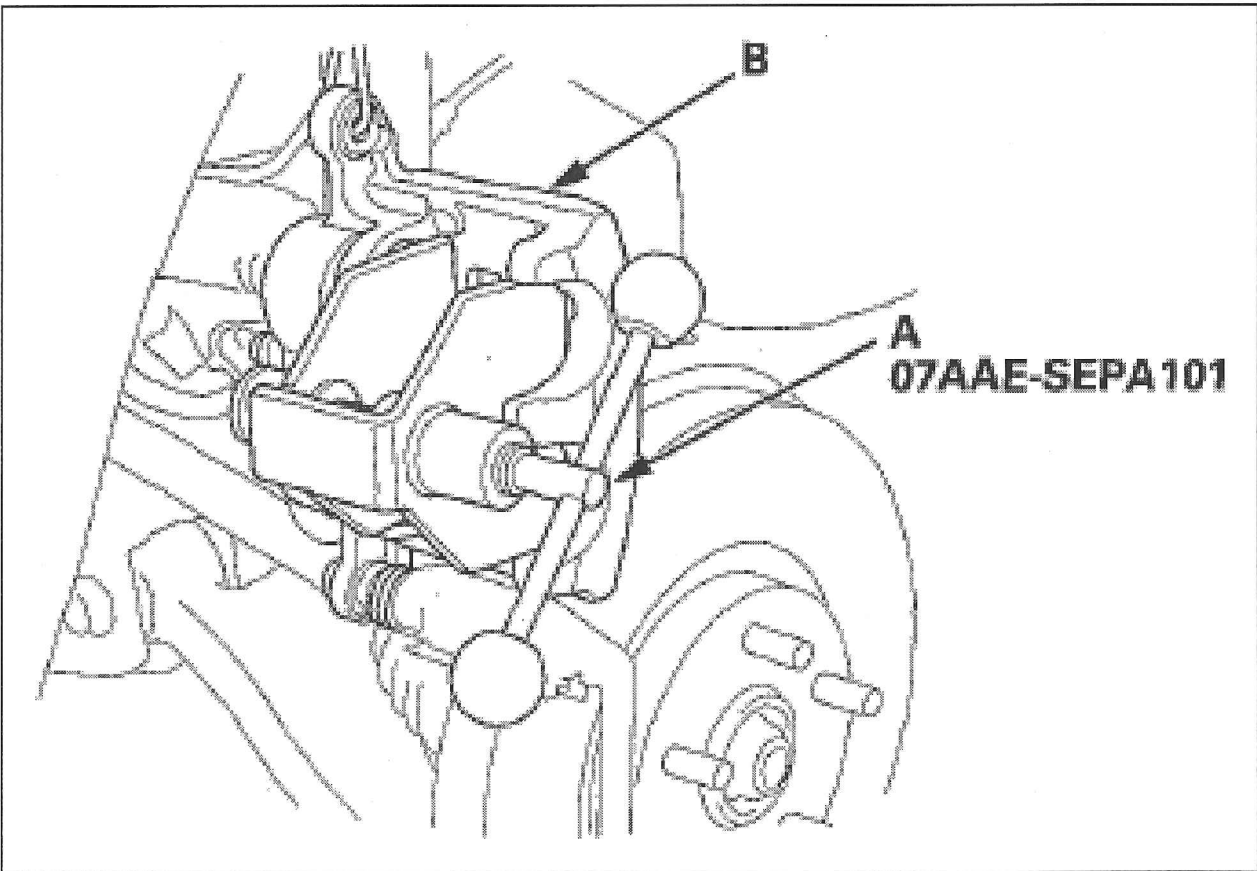

Courtesy of AMERICAN HONDA MOTOR CO., INC.

13. Press in the piston with the brake caliper piston compressor tool so the caliper will fit over the brake pads. Make sure the piston boot is in position to prevent damaging it when pivoting the caliper down,

NOTE: Be careful when pressing in the piston; brake fluid might overflow from the master cylinder's reservoir. If brake fluid gets on any painted surface, wash it off immediately with water.

14. Remove the brake caliper piston compressor tool.
15. Apply a thin coat of M-77 assembly paste (P/N 08798-9010) to the pad side of the shims (A), the back of the brake pads (B) and the other areas indicated by the arrows. Wipe excess assembly paste off the pad shims and the brake pads friction material. Keep grease and assembly paste off the brake disc and brake pads. Contaminated brake disc or brake pads reduce stopping ability.

Fig 6: Identifying Grease Applying Areas

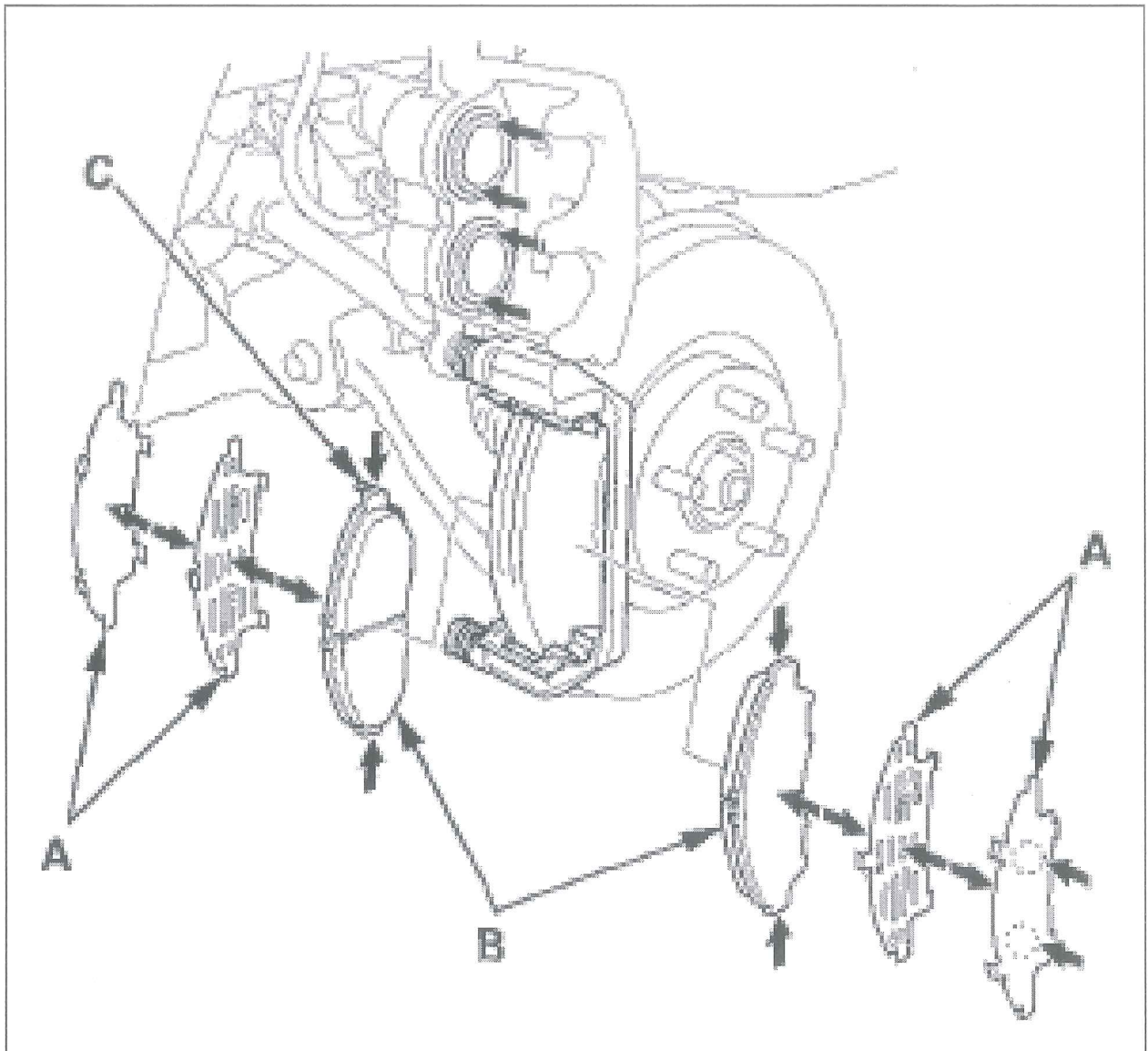

Courtesy of AMERICAN HONDA MOTOR CO., INC.

16. Install the brake pads and pad shims correctly. Install the brake pad with the wear indicator (C) on the upper inside. If you are reusing the brake pads, always reinstall the brake pads in their original positions to prevent a temporary loss of braking efficiency.
17. Install the pad springs (A) while holding the brake pads.

Fig 7: Identifying Pad Springs

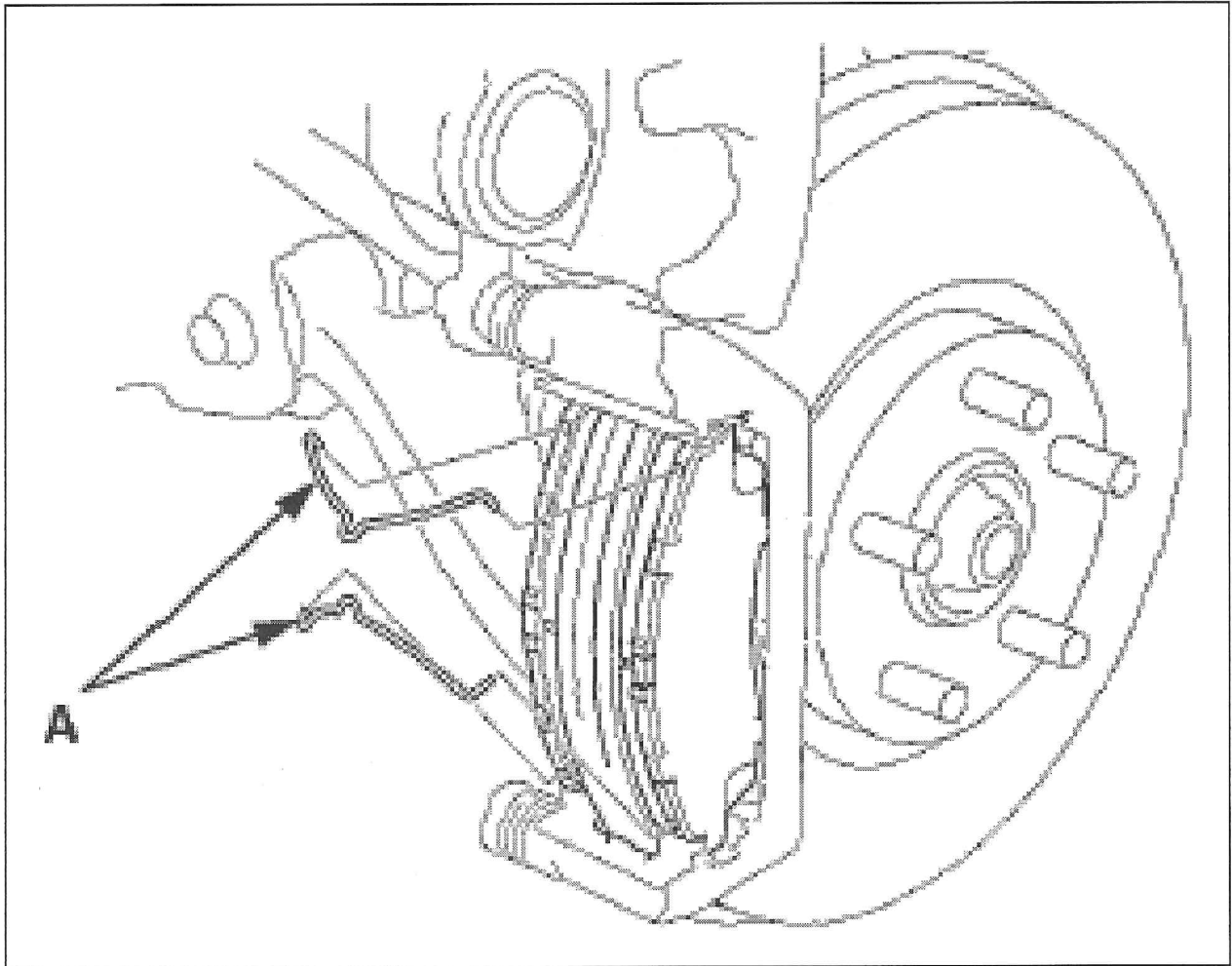

Courtesy of AMERICAN HONDA MOTOR CO., INC.

18. Pivot the caliper down into position, while holding the brake pads. Install the flange bolt (A), and tighten it to the specified torque.

Fig 8: Pivoting Caliper Down Into Position With Torque Specifications

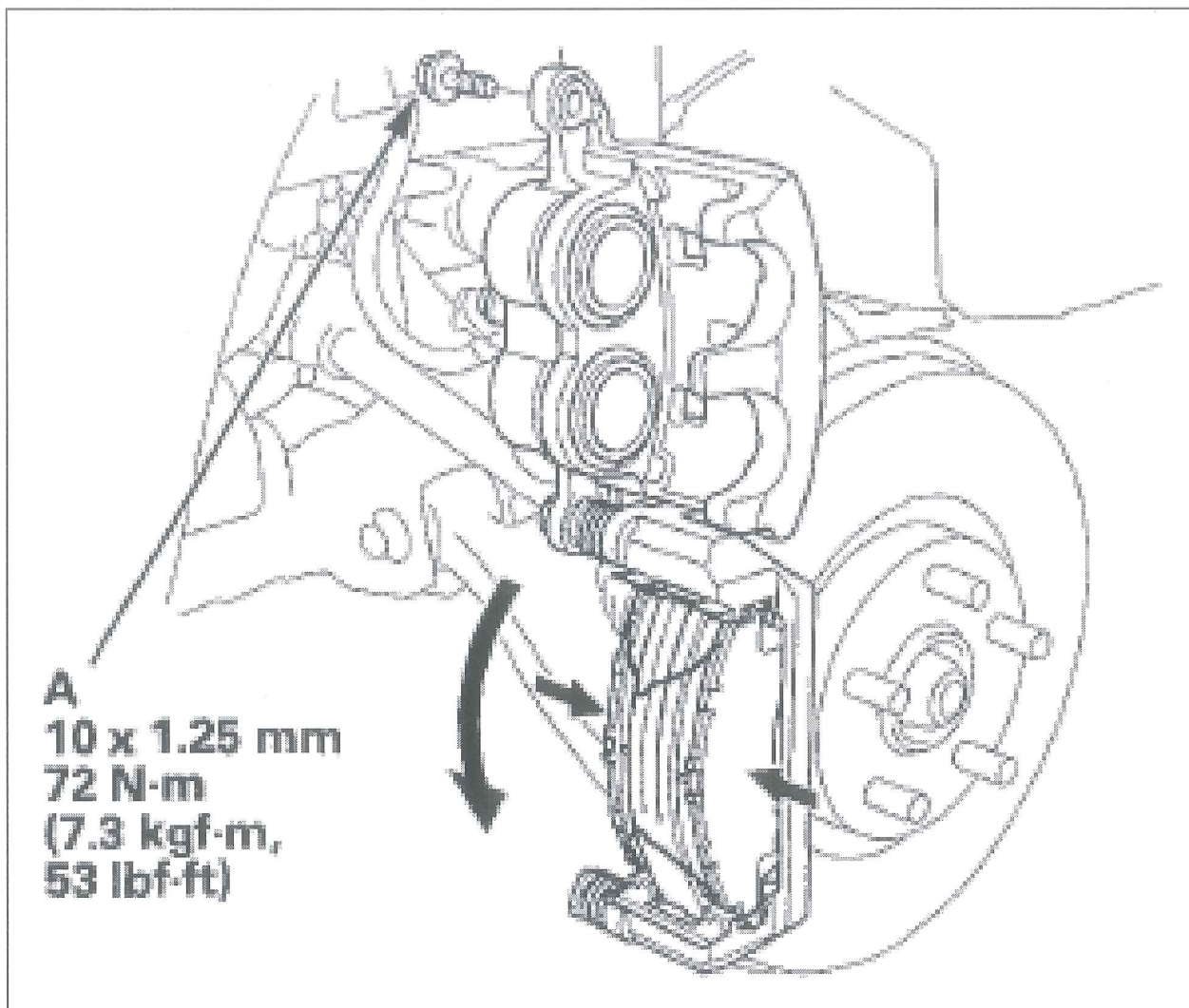

Courtesy of AMERICAN HONDA MOTOR CO., INC.

19. Clean the mating surfaces between the brake disc and the inside of the wheel, then install the front wheels.
20. Press the brake pedal several times to make sure the brakes work.

NOTE: *Engagement may require a greater pedal stroke immediately after the brake pads have been replaced as a set. Several applications of the brake pedal will restore the normal pedal stroke.*

21. Add brake fluid as needed.
22. After installation, check for leaks at hose and line joints or connections, and retighten if necessary. Test-drive the vehicle, then recheck for leaks (see BRAKE HOSE AND LINE INSPECTION).

