



École Banting Middle School

REPLACEMENT PROJECT

W e l c o m e

Public Open House, April 29, 2015
Hosted by: School District 43 Coquitlam



Purpose of Today's Open House

- To provide an overview for the replacement of École Banting Middle School
- To present the schematic concept for the new replacement school
- To present the proposed school grounds improvements
- To receive your feedback



École Banting Middle School
REPLACEMENT PROJECT

APRIL 29, 2015

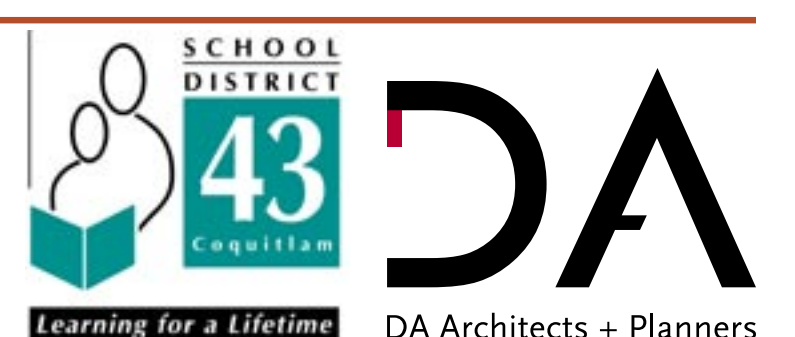

Renewing École Banting Middle School

Why Replacement?

SD43 has undertaken numerous seismic projects in the city, resulting in schools being fully or partially upgraded or completely replaced. Ensuring seismic safety and meeting the educational needs of each school are the key objectives of SD43.

École Banting Middle School has embarked on a school replacement process to create a seismically safe and upgraded school. The school has been rated to have a high seismic risk. It also has aging mechanical and electrical systems, and does not meet current life safety requirements such as sprinklers and accessibility.

The critical need to create a safer facility has opened up an opportunity to renew the entire school to support contemporary curriculum needs, create a much more sustainable building, and envision the school as a community-serving Neighborhood Learning Centre (NLC).

This project received support from the Coquitlam School District and the Ministry of Education.

The project is now going through detailed design. A Building Permit submission is scheduled for late 2015 and construction of the new building will start in Spring 2016.



École Banting Middle School
REPLACEMENT PROJECT

APRIL 29, 2015

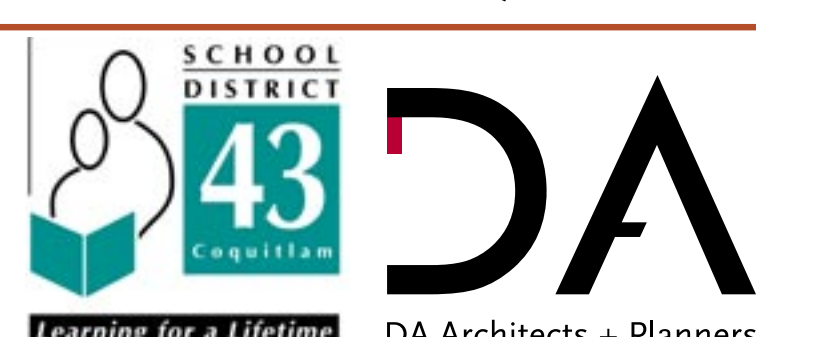

The Planning Process

Overall Process

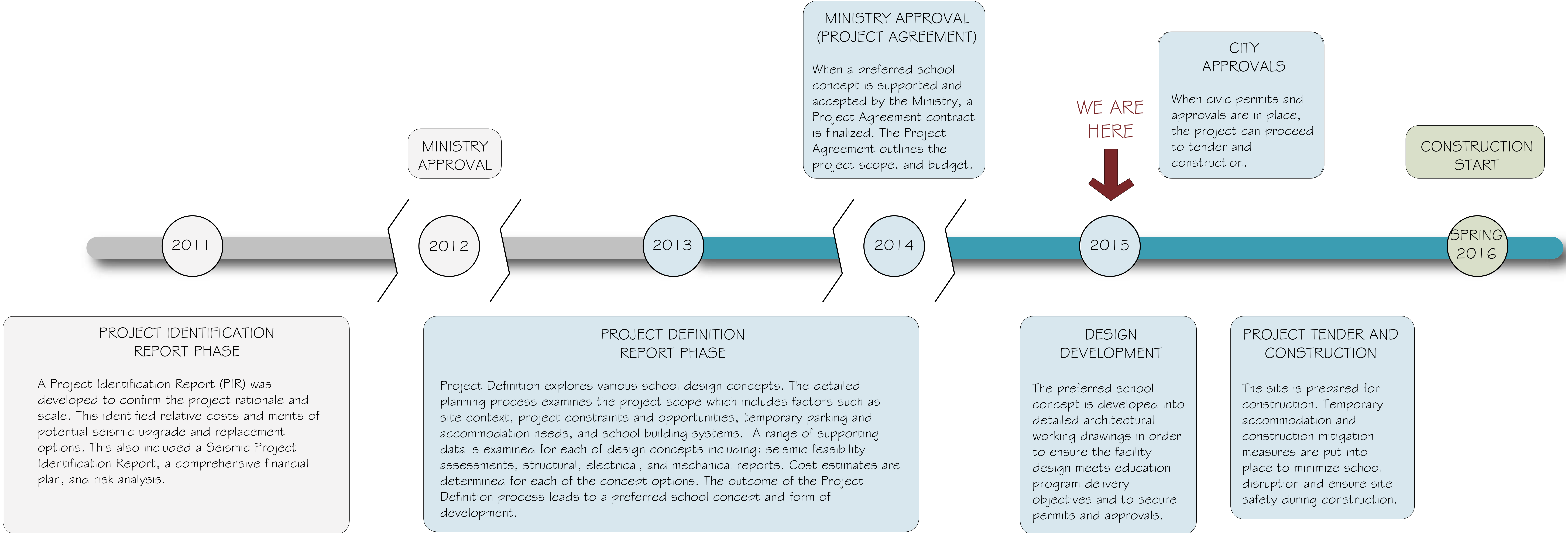

École Banting Middle School
REPLACEMENT PROJECT

APRIL 29, 2015



Key Planning Objectives

New Learning Environments

21st Century Learning principles address how middle schools are designed to match the way education is delivered in a modern context. There are many varieties of these models, ranging from a traditional classroom layout to a more integrated series of rooms for flexible and specialized teaching.

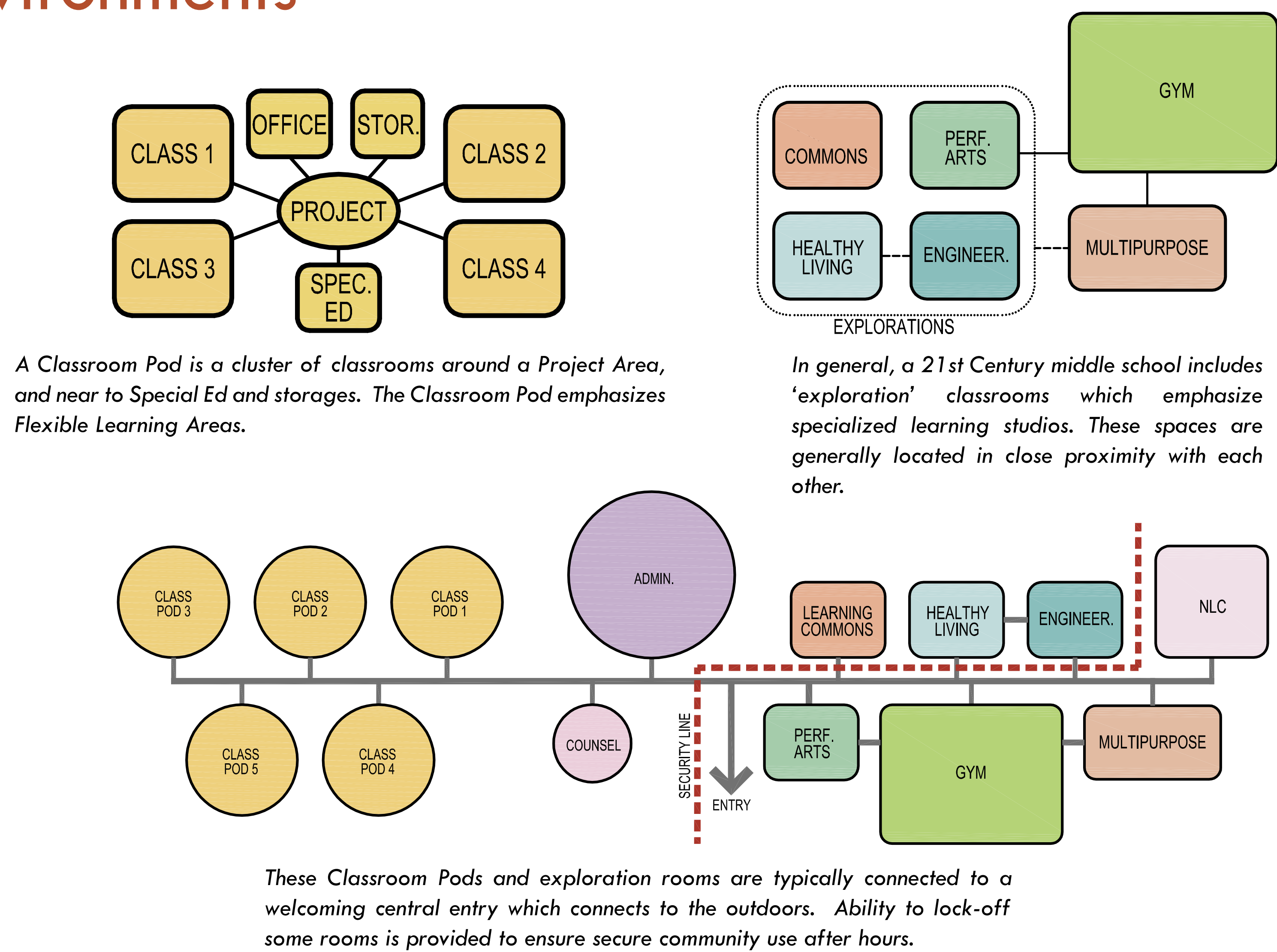

Sustainability Objectives

- The replacement school will undertake LEED® Gold certification
- A number of sustainable strategies have been identified

SITE AND WATER

- Management of stormwater on the site
- Maximize outdoor open space
- Water-efficient plumbing

ENERGY

- Low energy consuming lighting and high efficiency glazing
- High quality mechanical and HVAC systems
- Sun shading
- Highly insulated walls and roofs

OTHER CONSIDERATIONS

OPERATIONS

- Proper equipment commissioning

EDUCATION

- School recycling & material sorting programs
- Using the building & grounds to teach sustainability and environmental stewardship

RESOURCES

- Building materials with high recycled content and available locally
- Re-use of existing building elements

HEALTH & WELLBEING

- Natural light and ventilation
- Reduced light pollution

Implementation + Phasing

- Replacement of an existing school requires carefully considered construction and phasing procedures
- Implementation considerations include: minimizing disruption to the school, site safety, total project length, and temporary accommodation of school functions.
- All school functions are accommodated on site.
- The sequence of the implementation process is contained in the proposed phasing plan.



Neighborhood Fit

- The existing school building conveys a strong presence in the neighborhood and is a community focal point.
- The new school building while expressive of current educational program will maintain a strong physical presence in the community, support community use, and relate to the neighborhood and the Banting legacy.



École Banting Middle School REPLACEMENT PROJECT

APRIL 29, 2015

Traffic

The project's Traffic Consultant has completed a Draft Traffic Management Plan for the École Banting Middle replacement project.

- Avenue allows one-way through traffic with approximately 15 temporary drop-off/parking stalls. There will be sidewalk around the perimeter of the roundabout to provide pedestrian access to the main entrance of the school building.
- The new parking lot will be located on the east side of the roundabout and provide approximately 64 parking stalls. Entry and exit to the parking lot will be separated from the drop-off roundabout access.
- Vehicular traffic will be alleviated to the main entrances of the building by having these two separate drop-off locations, as well as having a separate access to the school parking lot. Students will have access to the building at three possible locations, and together with the new street parking, there will be a few options for parents to drop off their children.
- HASTe BC stands for “The Hub for Active School Travel”. It is a provincial lead for School Travel Planning in British Columbia and encourages more students to walk, scooter or bike to and from school. A few benefits of promoting active school travel include: **increased safety, Improved health, reduced traffic congestion near the school, and less air pollution.** École Banting Middle School is working together with the City of Coquitlam's School Travel Planning program to implement this initiative.

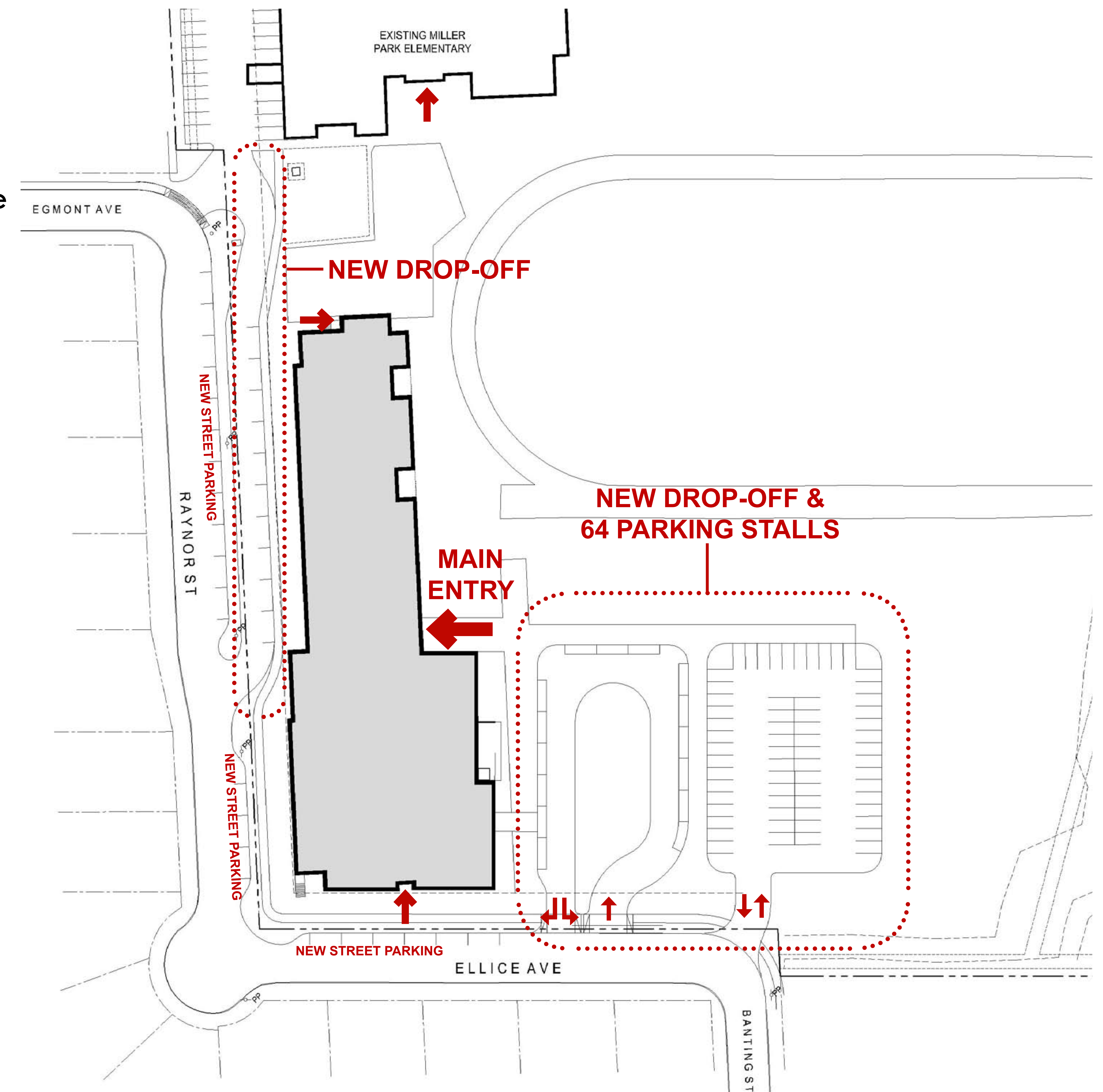

École Banting Middle School
REPLACEMENT PROJECT

APRIL 29, 2015



Preliminary Design

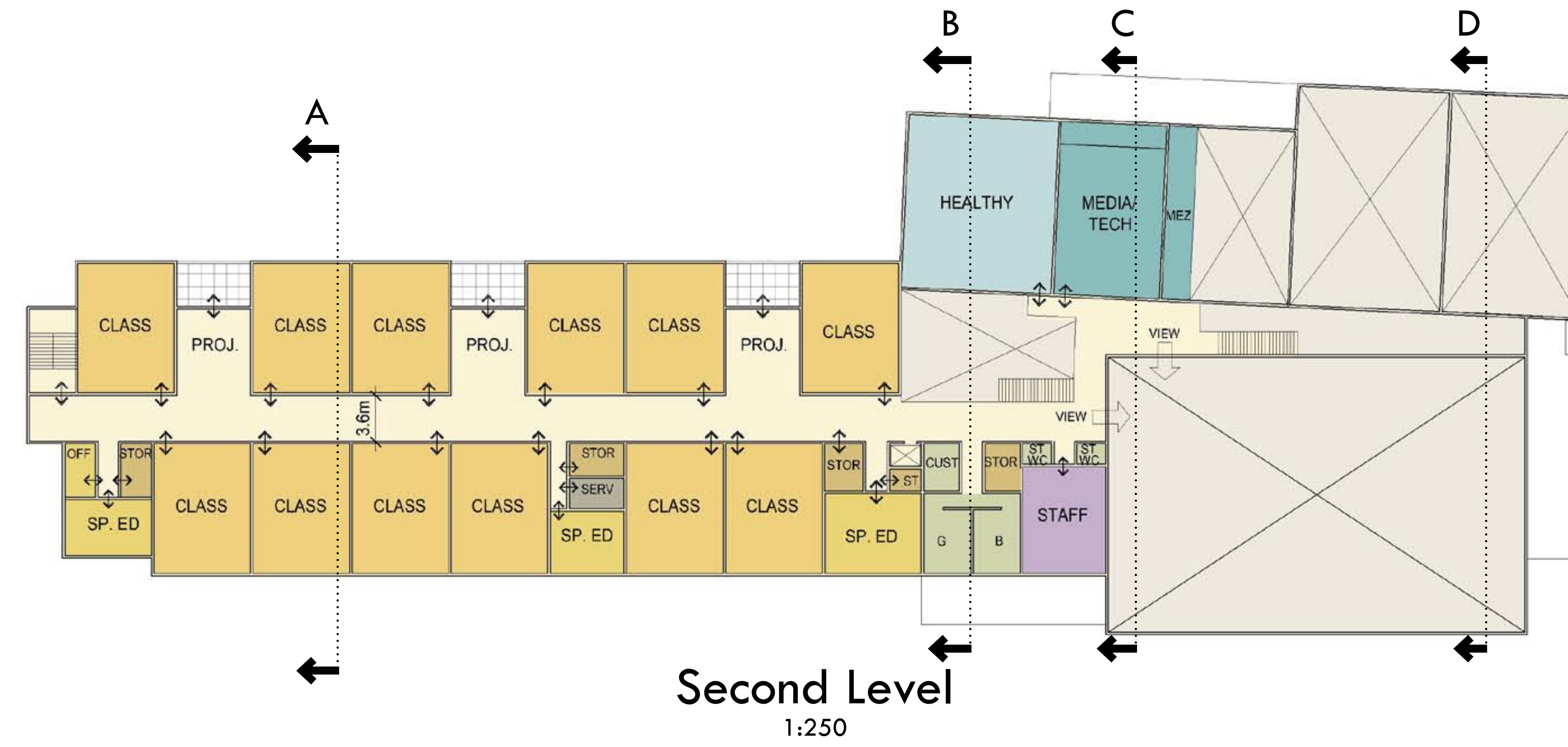

École Banting Middle School REPLACEMENT PROJECT

FLOOR PLANS



North Elevation
1:250



West Elevation
1:250



South Elevation
1:250



East Elevation
1:250



École Banting Middle School REPLACEMENT PROJECT

ELEVATIONS

- The existing school building will be demolished in phases to allow construction of the new school on the existing school site.
- During the construction of the new school, all school programs will be accommodated in the remaining existing building. No portables will be required.

PHASE 1

- West block of existing school demolished

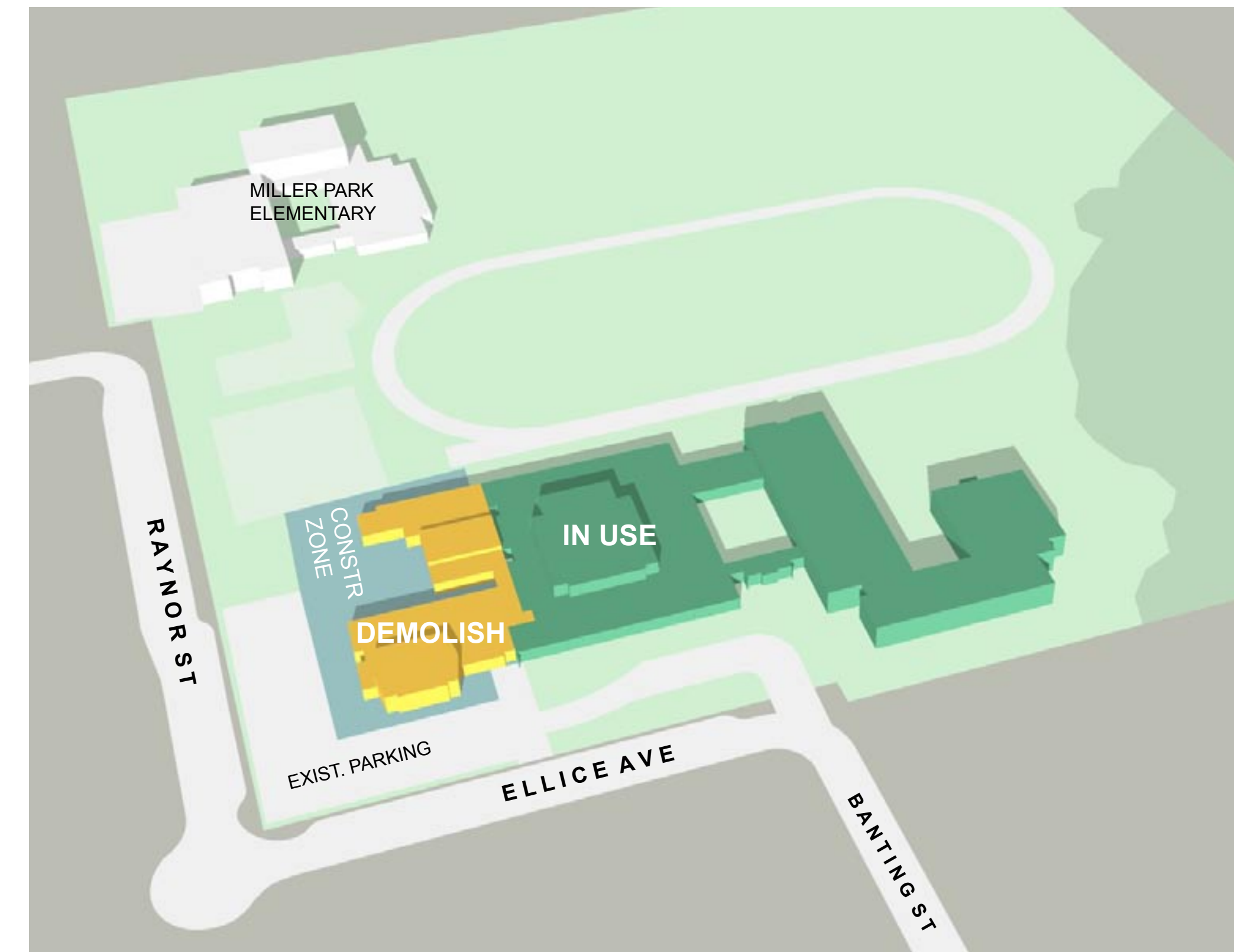

PHASE 2

- New shared drop-off along Raynor St.
- Existing parking removed. 56 temporary staff parking stalls accommodated north of Miller Park Elementary.

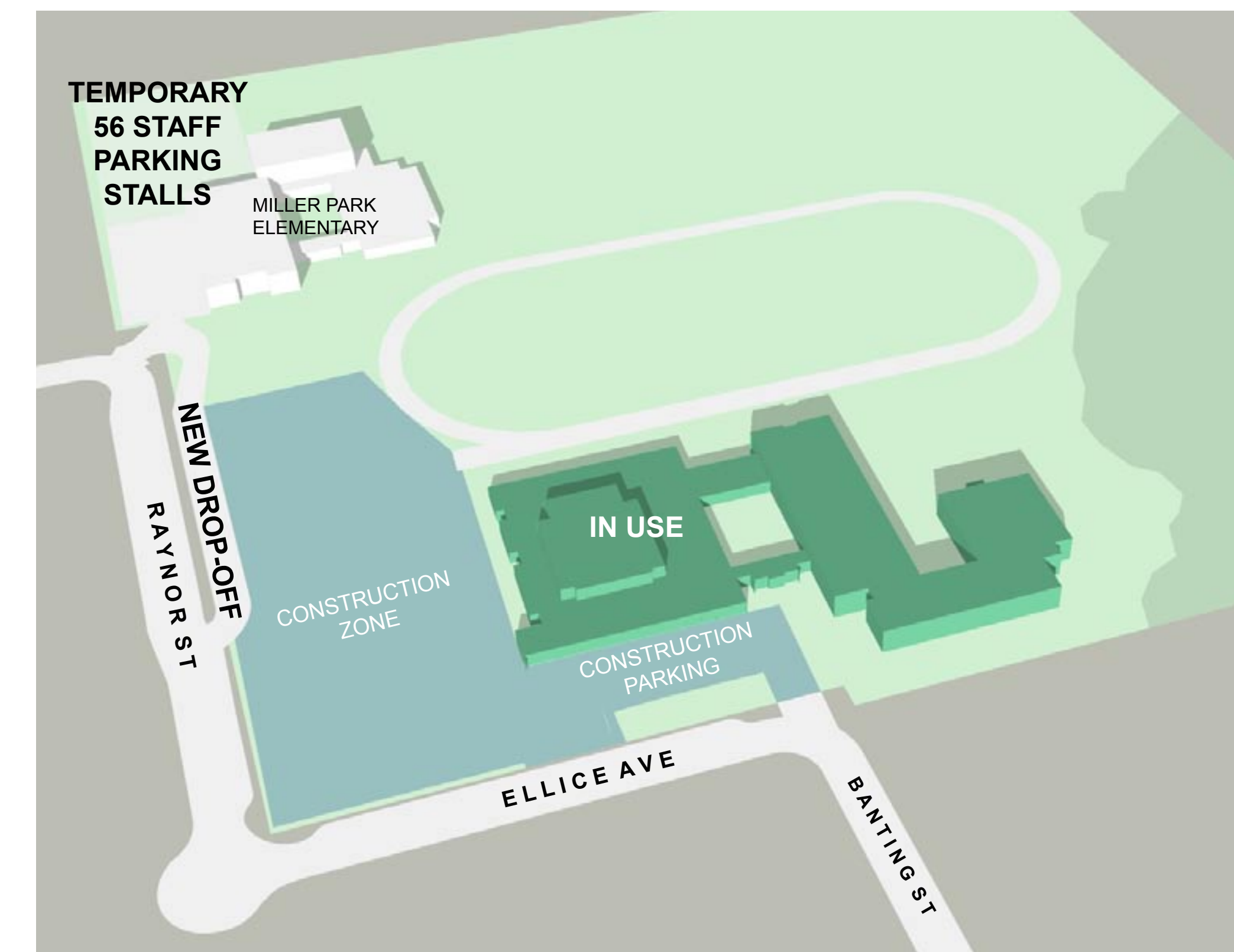

PHASE 3

- Construction of new school

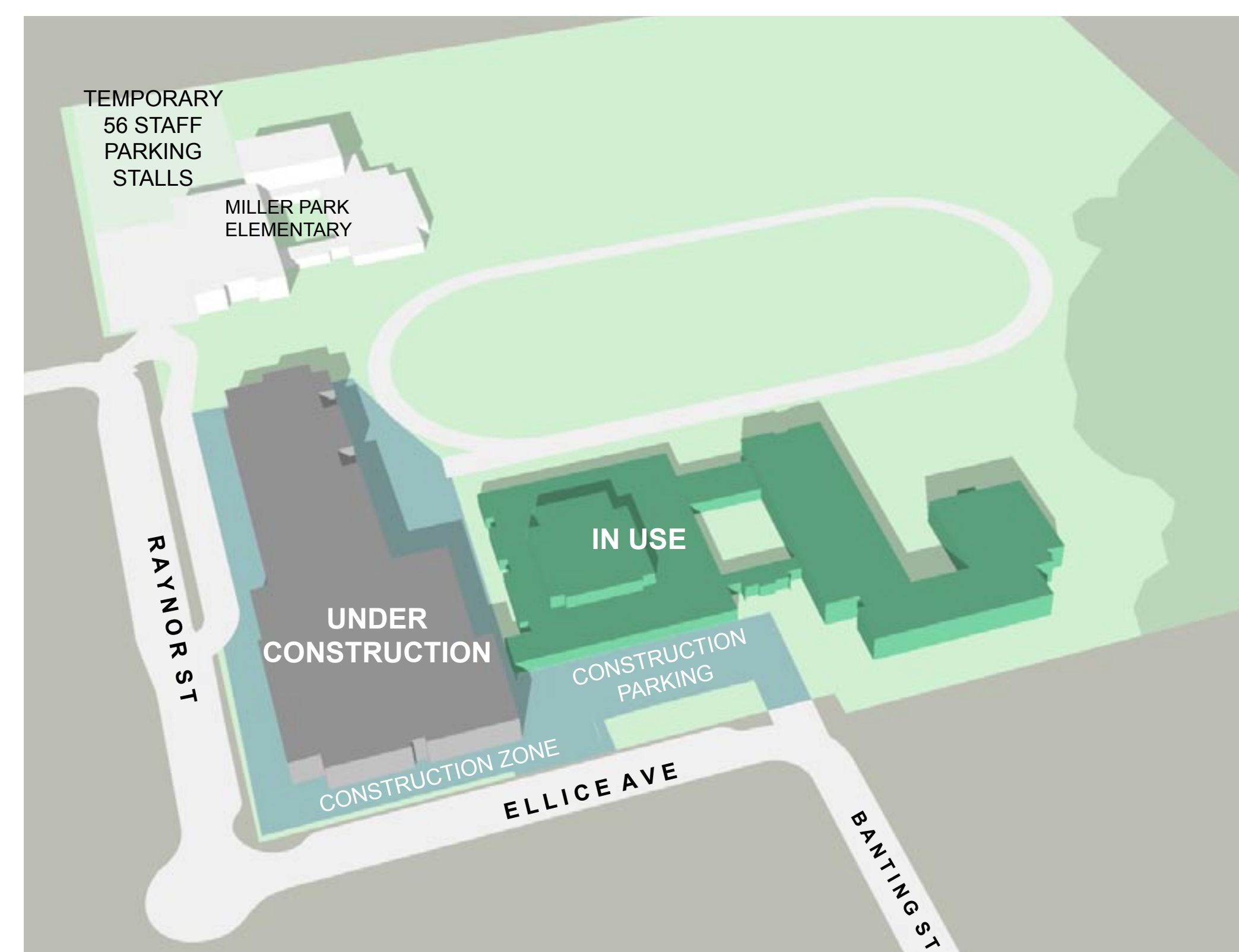

PHASE 4

- Occupy new school
- Demolish remaining existing school



PHASE 5

- New on-site drop-off and parking
- Landscaping and new play areas established

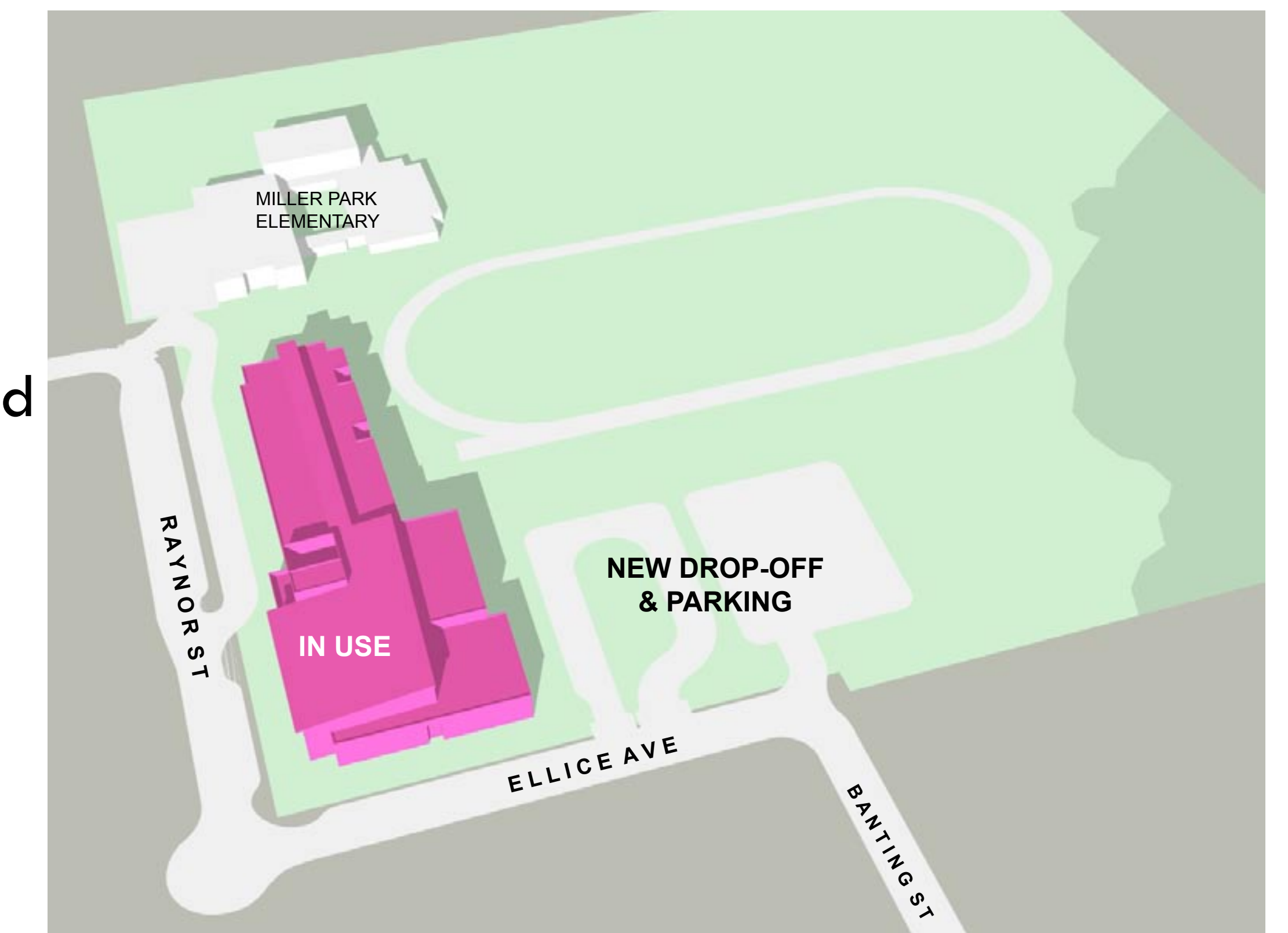

École Banting Middle School REPLACEMENT PROJECT

PHASING PLAN

- This Landscape Plan illustrates the site features that may be provided in the Banting Middle School Project.
- This Plan is subject to budget constraints and may require modifications to conform to funding availability.

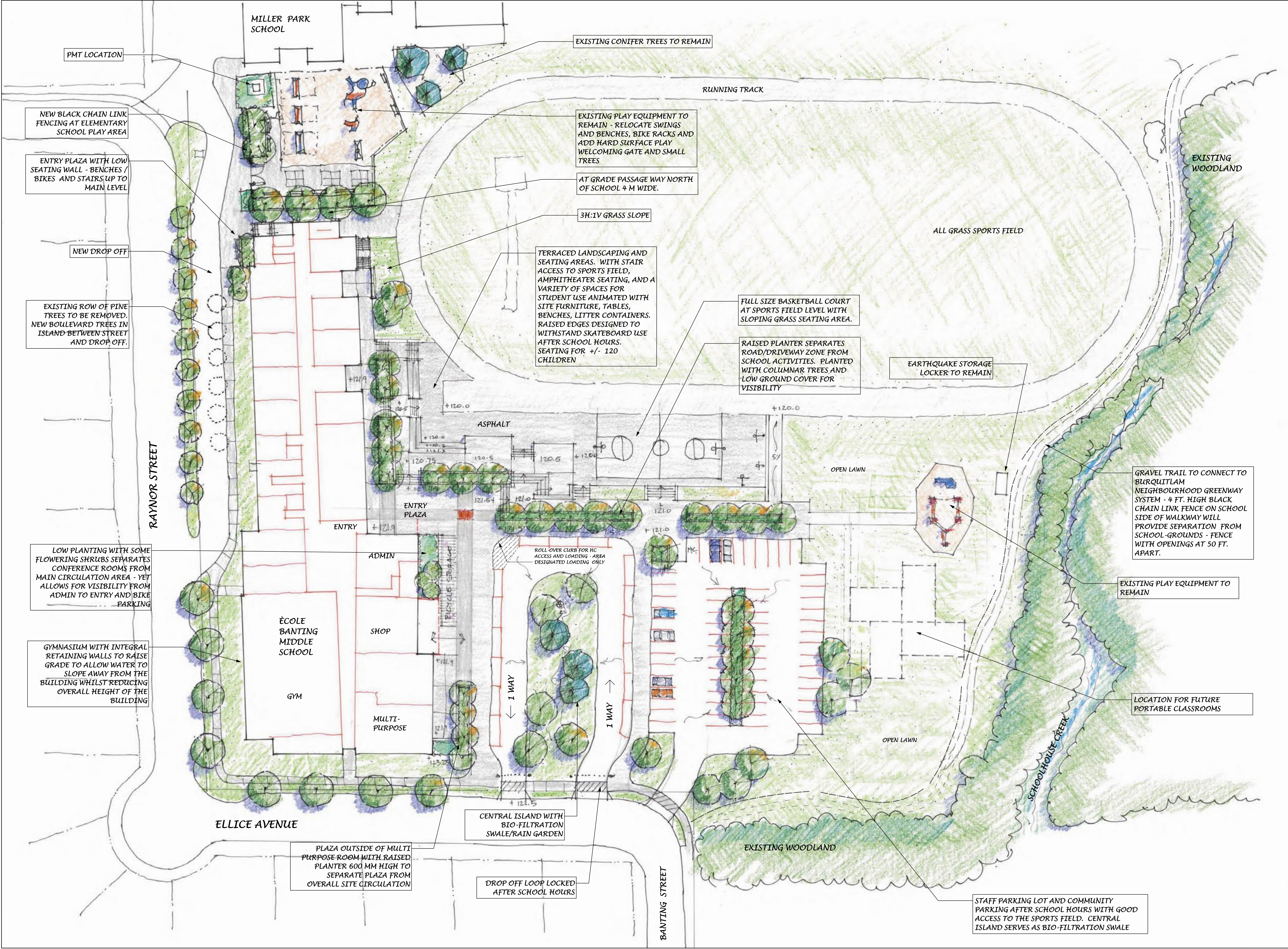

École Banting Middle School
REPLACEMENT PROJECT

LANDSCAPE PLAN



Basketball Court



Ball Hockey



Outdoor Chess Board



Amphitheater

LEARNING TERRACES



Rain Gardens (without stones)



Biofiltration Swales in Parking Lots

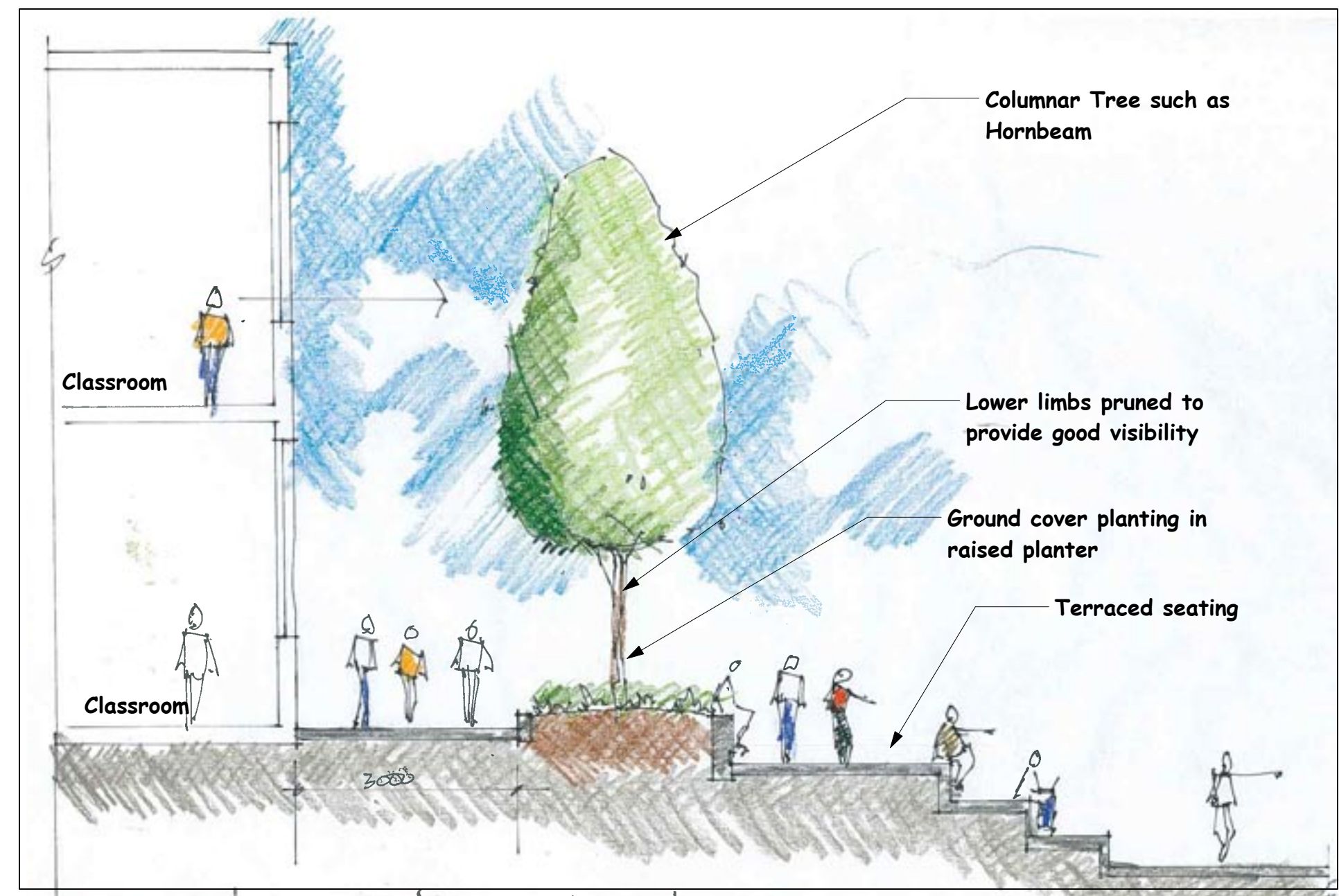

Section thru Classroom Wing, perimeter pathway, raised planter, and terraced seating



Biofiltration Swales in Parking Lots
STORMWATER MANAGEMENT



Coastal native planting - Swordfern



Coastal Strawberry and Redbud



Dwarf Arctic Willow - can be harvested for school art projects

PLANT MATERIAL



Columnar trees at edge of parking and near school



Picnic Table and Chessboard insert



Pole Mount LED Site Lighting



Cora Bicycle Racks



Litter & Recycling Containers

SITE FURNITURE



École Banting Middle School
REPLACEMENT PROJECT

LANDSCAPE IMAGE BOARD

Jonathan Losee Ltd. LANDSCAPE ARCHITECTURE

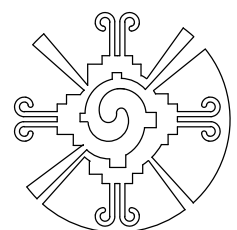

#102 - 1661 W. 2nd Avenue
Vancouver, B.C. V6J 1H3
Ph: 604-669-1003
email: info@jonathanlosee.com
web: jonathanlosee.com



Banting Middle Outline Schedule*

Next Steps

- Design Development to be completed in end of June 2015.
- Demolition of west block of existing building and subsequent construction of new building construction to commence in Spring 2016.

**This is a preliminary outline schedule. Actual timing will be subject to a variety of factors, including approvals from the City of Coquitlam and the Ministry of Education*

